

Verschlusschrauben Kunststoff

Synthetic locking plugs

Gewinde metrisch | Metric thread

Material: Polyamid PA 6
 Einsatztemperatur: -30°C / +100°C
 Schutzart: IP 54
 Weitere Schutzart: IP 68, wenn Anschlussge-
 winde abgedichtet

Material: Polyamide PA 6
 Temperature range: -30°C / +100°C
 Protection class: IP 54
 Further protection: IP 68, if the entry thread
 is sealed

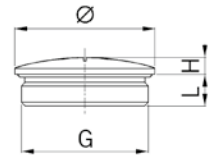

Hellgrau RAL 7035 ohne O-Ring				Light grey RAL 7035 without O-Ring	
G	Ø mm	H mm	L mm	Art.-Nr. Art. No.	
M12x1.5	15	4.5	6	8855.12	100
M16x1.5	20	4.5	6	8855.17	100
M20x1.5	24	4.5	6	8855.20	100
M25x1.5	30	5.0	8	8855.25	100
M32x1.5	37	5.5	8	8855.32	50
M40x1.5	46	6.0	8	8855.40	50
M50x1.5	56	6.0	10	8855.50	10
M63x1.5	70	6.0	12	8855.63	10



Schwarz RAL 9005 ohne O-Ring				Black RAL 9005 without O-Ring	
G	Ø mm	H mm	L mm	Art.-Nr. Art. No.	
M12x1.5	15	4.5	6	8845.12	100
M16x1.5	20	4.5	6	8845.17	100
M20x1.5	24	4.5	6	8845.20	100
M25x1.5	30	5.0	8	8845.25	100
M32x1.5	37	5.5	8	8845.32	50
M40x1.5	46	6.0	8	8845.40	50
M50x1.5	56	6.0	10	8845.50	10
M63x1.5	70	6.0	12	8845.63	10



Anschlussgewinde Pg | Entry thread Pg

Material: schlagfestes Material:
 Polypropylen
 Einsatztemperatur: -20°C / +80°C
 Schutzart: IP 54, IP 68 wenn An-
 schlussgewinde abge-
 dichtet

Material: Shock-resistant polysty-
 rene
 Temperature range: -20°C / +80°C
 Protection class: IP 54, IP 68 if the thread
 is sealed

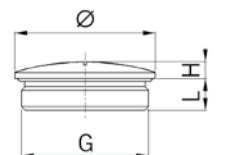

Hellgrau RAL 7035 ohne O-Ring				Light grey RAL 7035 without O-Ring	
G	Ø mm	H mm	L mm	Art.-Nr. Art. No.	
Pg 7	15	2.0	6.0	8807	100
Pg 9	19	3.0	6.5	8809	100
Pg 11	22	3.5	6.5	8811	100
Pg 13	25	3.5	6.5	8813	100
Pg 16	27	3.5	6.5	8816	100
Pg 21	33	4.0	8.0	8821	100
Pg 29	44	4.0	8.0	8829	50
Pg 36	55	4.0	10.0	8836	25
Pg 42	62	6.0	10.0	8842	10
Pg 48	69	5.0	12.0	8848.48	25

